

TECHNICAL MANUAL

**ORGANIZATIONAL, DIRECT SUPPORT, AND GENERAL SUPPORT
MAINTENANCE REPAIR PARTS AND SPECIAL TOOLS LIST
(INCLUDING DEPOT MAINTENANCE REPAIR PARTS AND SPECIAL TOOLS)**

FOR

**NAVIGATION SET, LORAN AN/PSN-6(V)
(NSN 5825-01-072-7989)**

HEADQUARTERS, DEPARTMENT OF THE ARMY

31 AUGUST 1981

**ORGANIZATIONAL, DIRECT SUPPORT, AND GENERAL SUPPORT
MAINTENANCE REPAIR PARTS AND SPECIAL TOOLS LIST
(INCLUDING DEPOT MAINTENANCE REPAIR PARTS AND SPECIAL TOOLS)
FOR
NAVIGATION SET, LORAN AN/PSN-6(V)
(NSN 5825-01-072-7989)
Current as of 30 March 1981**

REPORTING ERRORS AND RECOMMENDING IMPROVEMENTS

You can help improve this manual. If you find any mistakes or if you know of a way to improve the procedures, please let us know. Mail your letter, DA Form 2028 (Recommended Changes to Publications and Blank Forms), or DA Form 2028-2 located in back of this manual direct to: Commander, US Army Communications and Electronics Materiel Readiness Command, ATTN: DRSEL-ME-MQ, Fort Monmouth, NJ 07703.

In either case, a reply will be furnished direct to you.

Table of Contents

	Page	Ilus Figure
SECTION I. Introduction	1	
II. Repair Parts List.....	5	
GROUP 00 Navigation Set, LoranAN/PSN-6(V)	5	1
01 Receiver	11	2
0101 Analog Module 1A2 (No parts authorized)		
0102 Sensor Timing PCB 1A4 (No parts authorized)		
0103 Input/Output PCB 1A3 (No parts authorized)		
0104 Computer Board #1 1A6 (No parts authorized)		
0105 Computer Board #2 1A5 (No parts authorized)		
0106 Pre-Amplifier PCB 1A1 (No parts authorized)		
0107 Power Supply Assembly 1A7	11	2
0108 Interconnect CKT 1AB (No parts authorized)		
0109 Line Filters FL1, FL2, FL3 (No parts authorized)		
0110 Antenna Mount Assembly (No parts authorized)		
GROUP 02 Control Indicator C-9547/PSN-6	15	3
0201 Control Logic Module 2A1 (No parts authorized)		
0202 Displays (No parts authorized)		
0203 Cable Assembly (No parts authorized)		
03 Vehicle Mount Adapter.....	19	4
0301 Power Supply 3PS1 (No parts authorized)		
0302 Overvoltage Protection (No parts authorized)		
SECTION III. Special Tools List (Not applicable)		
IV. National Stock Number and Part Number Index.....	21	

***This manual supersedes TM 11-5826-251-24P, 30 March 1979.**

**SECTION I
INTRODUCTION**

1. Scope

This manual lists spares and repair parts; special tools; special test, measurement, and diagnostic equipment (TMDE), and other special support equipment required for performance of organizational, direct support, and general support maintenance of the AN/PSN-6. It authorizes the requisitioning and issue of spares and repair parts as indicated by the source and maintenance codes.

2. General

This Repair Parts and Special Tools List is divided into the following sections:

a. Section II. Repair Parts List. A list of spares and repair parts authorized for use in the performance of maintenance. The list also includes parts which must be removed for replacement of the authorized parts. Parts lists are composed of functional groups in numeric sequence, with the parts in each group listed in figure and item number sequence.

b. Section III. Special Tools List. Not applicable.

c. Section IV. National Stock Number and Part Number Index. A list in National item identification number (NIIN) sequence, of all National stock numbers (NSN) appearing in the listings, followed by a list, in alphameric sequence, of all part numbers appearing in the listings. National stock numbers and part numbers are cross-referenced to each illustration figure and item number appearance.

3. Explanation of Columns

a. Illustration. This column is divided as follows:

(1) *Figure number.* Indicates the figure number of the illustration on which the item is shown.

(2) *Item number.* The number used to identify item called out in the illustration.

b. Source, Maintenance, and Recoverability (SMR) Codes.

(1) *Source code.* Source codes indicate the manner of acquiring support items for maintenance, repair, or overhaul of end items. Source codes are entered in the first and second positions of the Uniform SMR Code format as follows:

<i>Code</i>	<i>Definition</i>
PA	Item procured and stocked for anticipated or known usage.
PD	Support item, excluding support equipment, procured for initial issue or outfitting and stocked only for subsequent or additional initial issues or outfittings. Not subject to automatic replenishment.
XD	A support item that is not stocked. When required, item will be procured through normal supply channels

NOTE

Cannibalization or salvage may be used as a source of supply for any items source coded above except those coded XA and aircraft support items as restricted by AR 700-42.

(2) *Maintenance code.* Maintenance codes are assigned to indicate the levels of maintenance authorized to USE and REPAIR support items. The maintenance codes are entered in the third and fourth positions of the Uniform SMR Code format as follows:

(a) The maintenance code entered in the third position will indicate the lowest maintenance level authorized to remove, replace, and use the support item. The maintenance code entered in the third position will indicate one of the following levels of maintenance:

<i>Code</i>	<i>Application/Explanation</i>
O	Support item is removed, replaced, used at the organizational level
H	Support item is removed, replaced, used at the general support level
D	Support items that are removed, replaced, used at depot, mobile depot, specialized repair activity only.

(b) The maintenance code entered in the fourth position indicates whether the item is to be repaired and identifies the lowest maintenance level with the capability to perform complete repair (i.e., all authorized maintenance functions). This position will contain one of the following maintenance codes:

<i>Code</i>	<i>Application/Explanation</i>
H -	The lowest maintenance level capable of complete repair of the support item is the general support level.
D -	The lowest maintenance level capable of complete repair of the support item is the depot level.
Z -	Nonreparable. No repair is authorized.

(3) *Recoverability code.* Recoverability codes are assigned to support items to indicate the disposition action on unserviceable items. The recoverability code is entered in the fifth position of the Uniform SMR Code format as follows:

<i>Recoverability codes</i>	<i>Definition</i>
Z -	Nonreparable item. When unserviceable, condemn and dispose at the level indicated in position 3.
H -	Reparable item. When uneconomically reparable, condemn and dispose at the general support level.
D -	Reparable item. When beyond lower level repair capability, return to depot. Condemnation and disposal not authorized below depot level
L -	Reparable item. Repair, condemnation, and disposal not authorized below depot/specialized repair activity level.
A -	Item requires special handling or condemnation procedures because of specific reasons (i.e., precious metal content, high dollar value, critical material or hazardous material). Refer to appropriate manuals/directives for specific instructions.

c. National Stock Number. Indicates the National stock number assigned to the item and will be used for requisitioning purposes.

d. Federal Supply Code for Manufacturer (FSCM). The FSCM is a 5-digit numeric code listed in SB 708-41/42 which is used to identify the manufacturer, distributor, or Government agency, etc.

e. Part Number. Indicates the primary number used by the manufacturer (individual, company, firm, corporation, or Government activity), which controls the design and characteristics of the item by means of its engineering drawings, specifications, standards, and inspection requirements to identify an item or range of items.

NOTE

When a stock numbered item is requisitioned, the repair part received may have a different part number than the part being replaced.

f. Description. Indicates the Federal item name, and if required, a minimum description to identify the item.

g. Unit of Measure (U/M). Indicates the standard of the basic quantity of the listed item as used in performing the actual maintenance function. This measure is expressed by a two-character alphabetical abbreviation (e.g., ea, in, pr, etc). When the unit of measure differs from the unit of issue, the lowest unit of issue that will satisfy the required units of measure will be requisitioned.

h. Quantity Incorporated in Unit. Indicates the quantity of the item used in the breakout shown on the illustration figure, which is prepared for a functional group, subfunctional group, or an assembly.

4. Special Information

a. Usable on codes are shown in the description column. Uncoded items are applicable to all models. Identification of the usable on codes used in this publication are:

<i>Code</i>	<i>Used on</i>
DIL	AN/PSN-6(V)
DIM	Vehicle Mount Adapter

b. The following publications pertain to the AN/PSN-6(V) and its components:

TM 11-5826-251-12, Navigation Set, Position Fixing Loran AN/PSN-6 and Vehicle Mount Adapter Group OF-34/PSN-6

TM 11-5826-251-34, Navigation Set, Position Fixing Loran AN/PSN-6 and Vehicle Mount Adapter Group OF-34/PSN-6

5. How to Locate Repair Pods

a. When National stock number or part number is unknown.

(1) *First.* Using the table of contents, determine the functional group within which the item belongs. This is necessary since illustrations are prepared for functional groups and listings are divided into the same groups.

(2) *Second.* Find the illustration covering the functional group to which the item belongs.

(3) *Third.* Identify the item on the illustration and note the illustration figure and item number of the item.

(4) *Fourth.* Using the Repair Parts Listing, find the figure and item number noted on the illustration.

b. When National stock number or part number is known.

(1) *First.* Using the Index of National Stock Numbers and Part Numbers, find the pertinent

National stock number or part number. This index is in NIIN sequence followed by a list of part numbers in alphameric sequence, cross-referenced to the illustration figure number and item number.

(2) *Second.* After finding the figure and item

(3) number, locate the figure and item number in the repair parts list.

6. Abbreviations

Not applicable.

(Next printed page is 4)

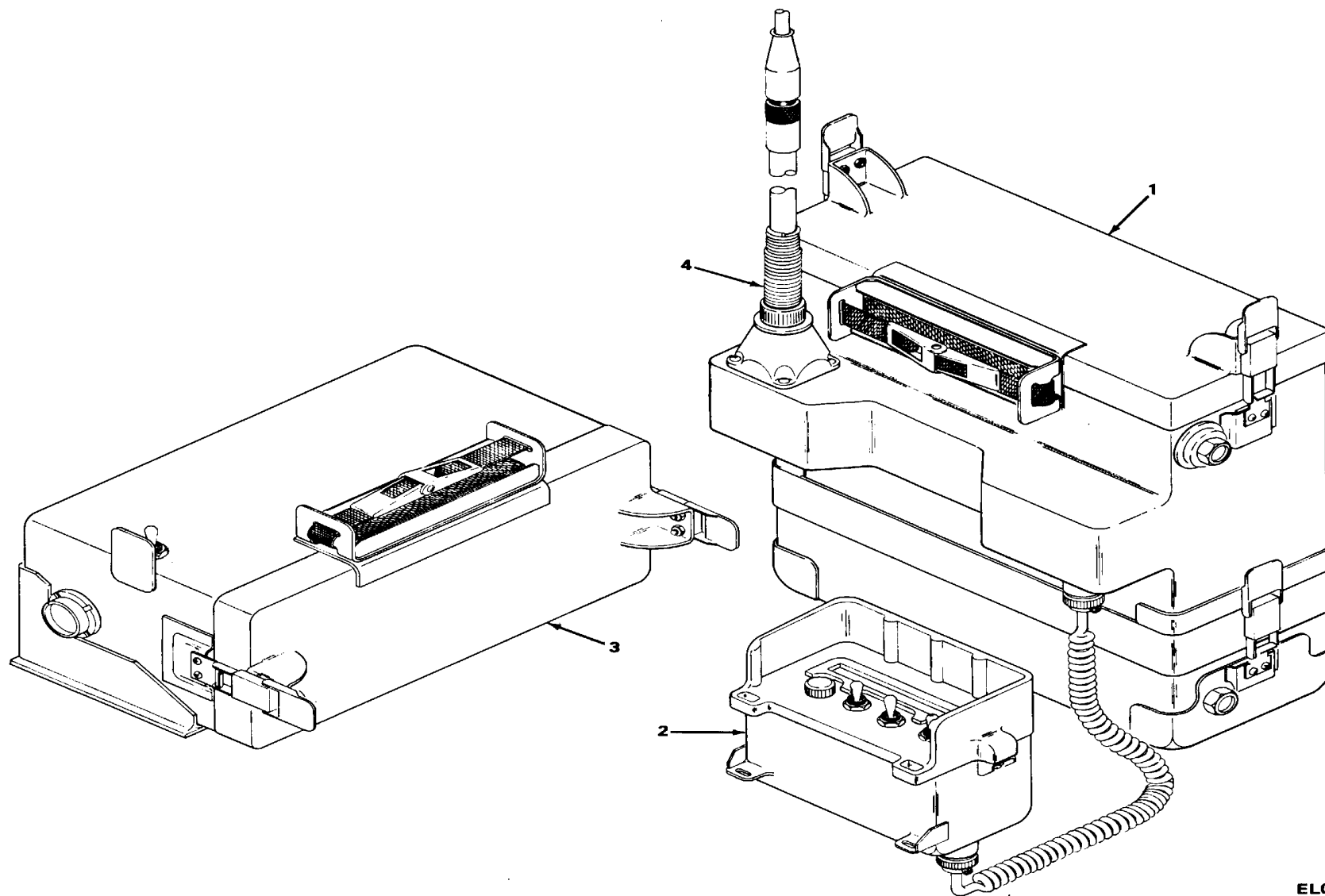

EL0CO001

Figure 1. Navigation Set, Loran AN/PSN-6(V).

SECTION II

TM 11-5826-251-24P

(1) ILLUSTRATION		(2)	(3)	(4)	(5)	(6)	(7)	(8)
(a) FIG NO.	(b) ITEM NO.	SMR CODE	NATIONAL STOCK NUMBER	FSCM	PART NUMBER	DESCRIPTION USABLE ON CODE	U/M	QTY INC IN UNIT
1	1	PAOHD	5825-01-076-8067	80063	SM-D-762604	GROUP 00 NIVAGATION SET, LOARN AN/ RECEIVER, LORAN..... DIL	EA	1
1	2	PDODD	5825-01-076-8067	80063	SM-D-761580	CONTROL-INDICATOR..... DIL	EA	1
1	3	PAOHD	5825-01-069-6872	80058	OF-34/PSN-6	VEHICLE MOUNT ADAPT..... DIM	EA	1
1	4	PAOHD	5820-00-889-3803	80058	AT-892/PRC-25	ANTENNA DIL	EA	1
5/(6 BLANK)								

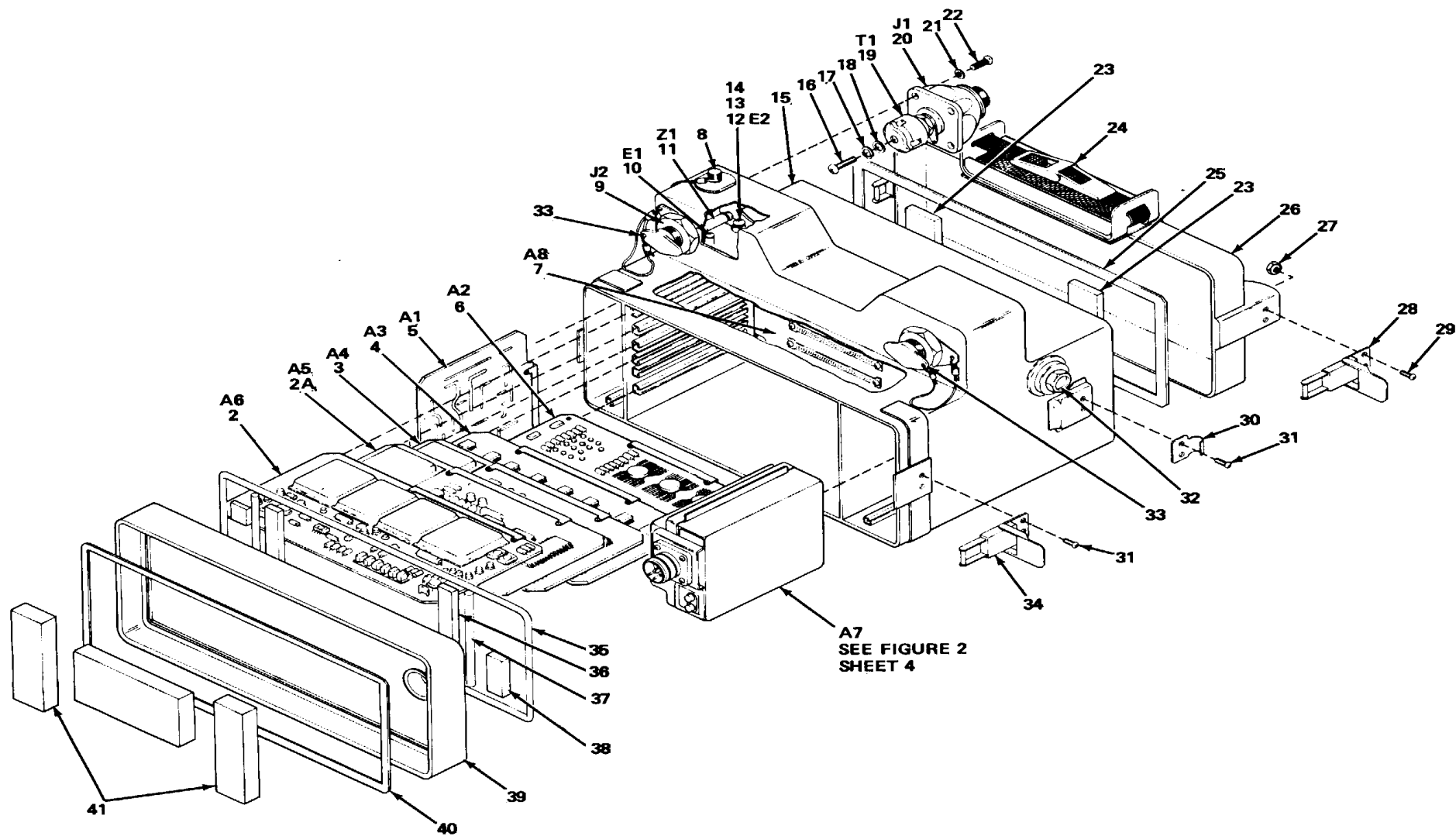

A7
SEE FIGURE 2
SHEET 4

ELOCO002

ITEM NO. 1 NOT USED.

Figure 2. Receiver (Sheet 1 of 4).

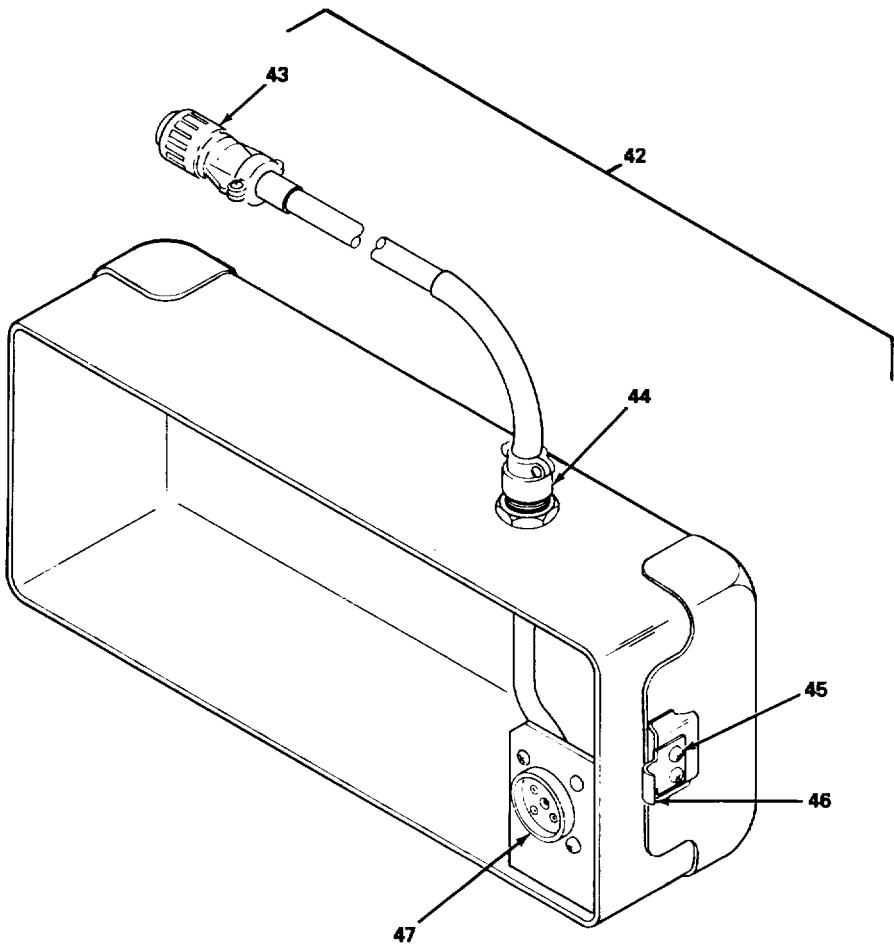

EL0C0003

Figure 2. Receiver (Sheet 2 of 4).

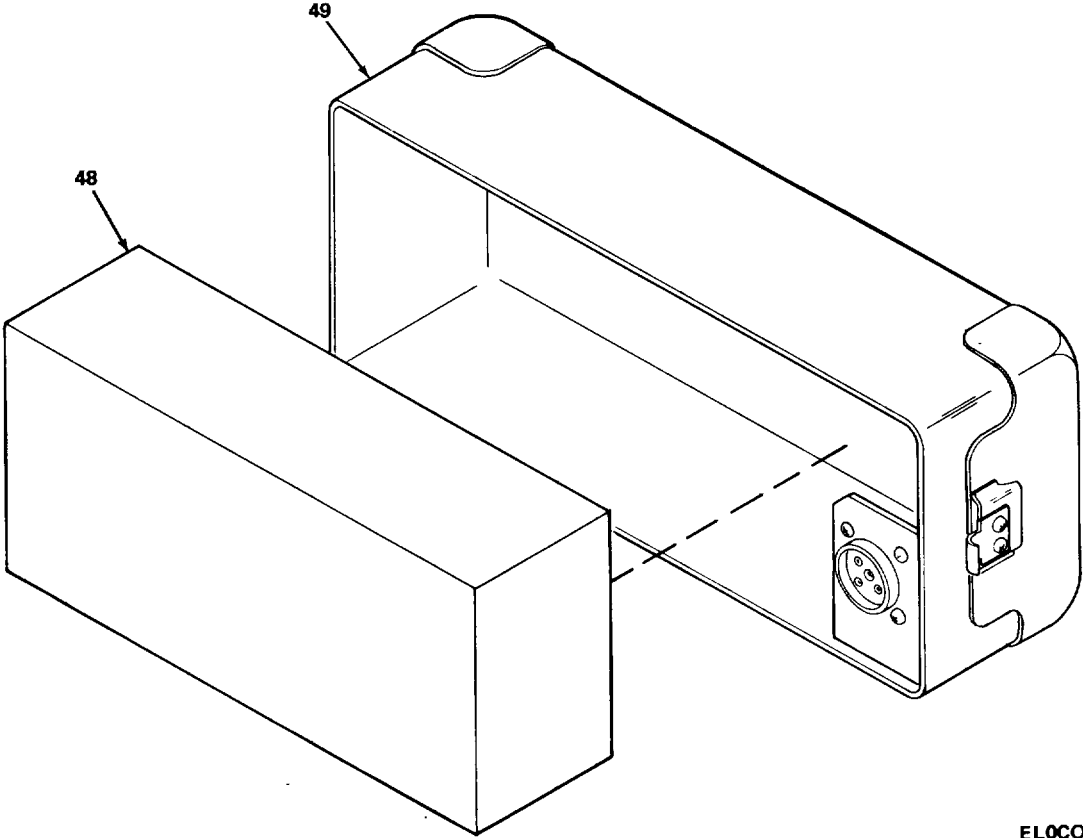

ELOCO004

Figure 2. Receiver (Sheet 3 of 4).

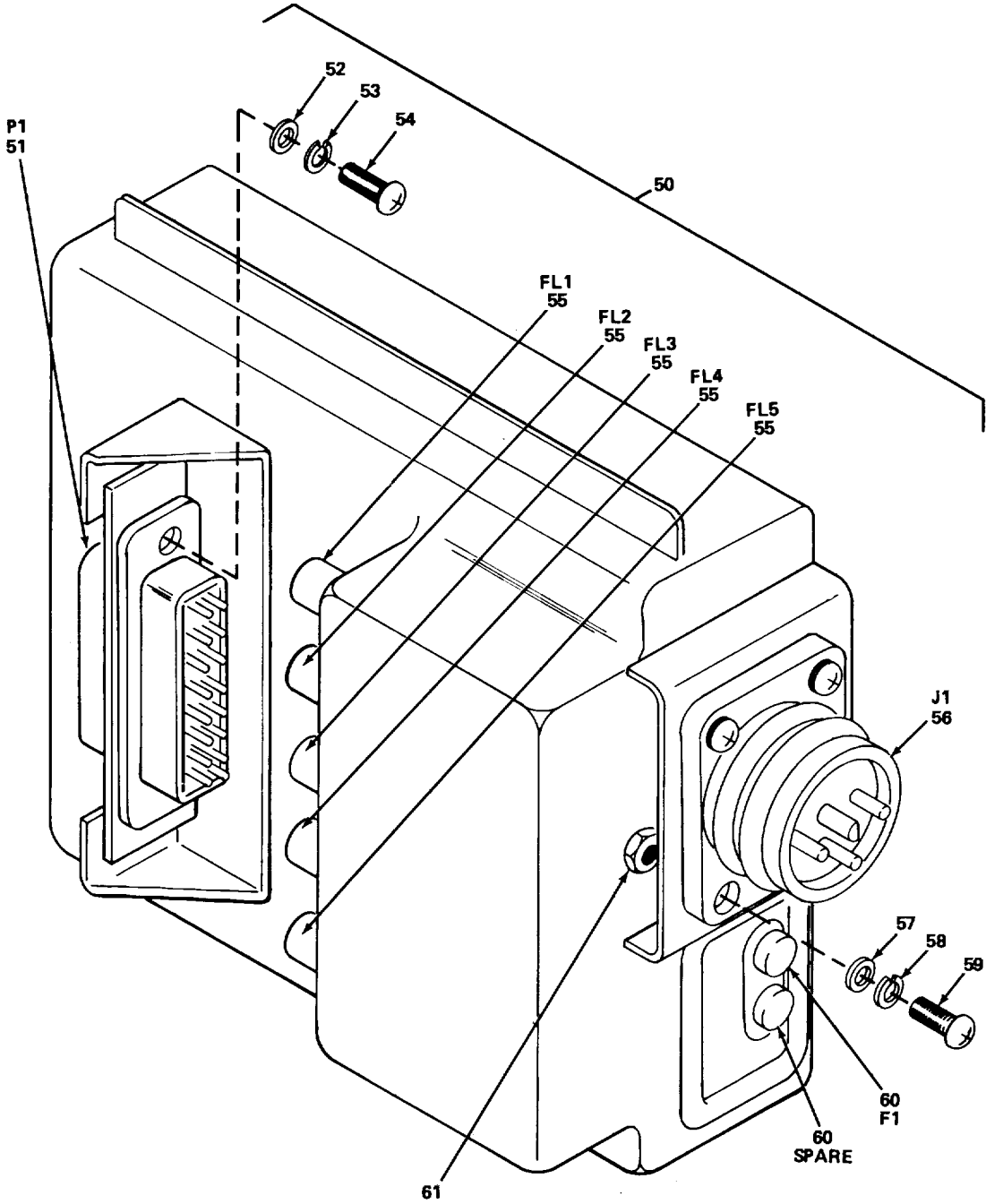

EL0C0006

Figure 2. Receiver Sheet (4 of 4).

SECTION II

TM 11-5826-251-24P

(1) ILLUSTRATION		(2)	(3)	(4)	(5)	(6)	(7)	(8)
(a) FIG NO.	(b) ITEM NO.	SMR CODE	NATIONAL STOCK NUMBER	FSCM	PART NUMBER	DESCRIPTION USABLE ON CODE	U/M	QTY INC IN UNIT
GROUP 01 RECEIVER								
2	2	XDHDL		80063	SM-D-762594	COMPUTER BOARD 1.....	DIL	EA 1
2	2A	XDHDL		80063	SM-D-762597	COMPUTER BOARD 2.....	DIL	EA 1
2	3	PAHDL	5825-01-051-4158	80063	SM-D-761496	CIRCUIT CARD ASSEMB.....	DIL	EA 1
2	4	PAHDL	5825-01-051-4145	80063	SM-D-762600	INPUT-OUTPUT MODULE.....	DIL	EA 1
2	5	PAHDL	5825-01-051-4159	80063	SM-D-761499	CIRCUIT CARD ASSEMB.....	DIL	EA 1
2	6	PAHDL	5825-01-051-4146	80063	SM-D-761536	ANALOG MODULE.....	DIL	EA 1
2	7	XDHHD		80063	SM-D-761687	INTCONN CKT CD ASSY.....	DIL	EA 1
2	8	PAHZZ	5985-01-084-5307	80063	SM-D-761598	CAP ASSEMBLY, PROTEC.....	DIL	EA 1
2	9	XDDZZ		96906	MS3114H128SW	CONNECTOR, RECEPTAC.....	DIL	EA 1
2	10	XDDZZ		81349	SE18E01	TERMINAL, STUD.....	DIL	EA 1
2	11	XDDZZ		74276	UMT(1)-550	ARRESTER, ELEC SURGE.....	DIL	EA 1
2	12	PADZZ	5940-00-682-2477	96906	MS77068-1	TERMINAL, LUG.....	DIL	EA 1
2	13	PADZZ	5305-00-054-5646	96906	MS51957-12	SCREW, MACHINE.....	DIL	EA 1
2	14	PADZZ	5310-00-934-9748	96906	MS35649-244	NUT, PLAIN, HEXAGON.....	DIL	EA 1
2	15	XDHHD		80063	SM-D-762590	CASE ASSEMBLY.....	DIL	EA 1
2	16	PADZZ	5305-00-054-5643	96906	MS51957-9	SCREW, MACHINE.....	DIL	EA 1
2	17	PADZZ	5310-00-928-2690	96906	MS35338-134	WASHER, LOCK.....	DIL	EA 1
2	18	PADZZ	5310-00-595-6761	96906	MS15795-802	WASHER, FLAT.....	DIL	EA 1
2	19	XDDZZ		80063	SM-D-762005	TRANSFORMER ASSY.....	DIL	EA 1
2	20	PAHZZ	5935-01-084-5309	80063	SM-C-761609	CONNECTOR, ANTENNA A.....	DIL	EA 1
2	21	PAHZZ	5310-00-722-5998	96906	MS15795-805	WASHER, FLAT.....	DIL	EA 4
2	22	PAHZZ	5305-00-054-6654	96906	MS51957-30	SCREW, MACHINE.....	DIL	EA 4
2	23	XDHZZ	5820-00-930-0724	80063	SM-B-447320	PAD.....	DIL	EA 2
2	24	PAHZZ	5340-01-086-8903	08992	CT1125	STRAP, WEBBING.....	DIL	EA 1
2	25	XDHZZ		80063	SM-C-761655	GASKET.....	DIL	EA 1
2	26	XDOHH		80063	SM-D-761658	COVER ASSY, PROT.....	DIL	EA 1
2	27	PAHZZ	5310-00-982-6813	96906	MS21044-C06	NUT, SELF-LOCKING, HE.....	DIL	EA 4
2	28	XDHZZ	5340-00-205-5184	14608	15834	CATCH, CLAMPING.....	DIL	EA 2
2	29	PAHZZ	5305-00-054-6652	96906	MS51957-28	SCREW, MACHINE.....	DIL	EA 4
2	30	PAHZZ	5340-00-134-3493	80063	SM-C-447321-2	STRIKE, CATCH.....	DIL	EA 2
2	31	PAHZZ	5305-00-054-6650	96906	MS51957-26	SCREW, MACHINE.....	DIL	EA 4
2	32	PAHZZ	4820-00-296-9677	81349	MILV55341	VALVE, PRESSURE RELI.....	DIL	EA 1
2	33	PAHZZ	5985-01-084-5308	80063	SM-D-761605	CAP ASSEMBLY, PROTEC.....	DIL	EA 1
2	34	PAHZZ	5340-00-236-0638	80063	SM-D-447321-1	CATCH, CLAMPING.....	DIL	EA 2
2	35	XDHZZ		18565	SM-A-761761-002	GASKET, SHIELDING.....	DIL	EA 1
2	36	XDHZZ		80063	SM-C-761617-2	PAD, CELLULAR, RUBBER.....	DIL	EA 2
2	37	XDHZZ		18565	SM-A-761761-001	GASKET, SHIELDING.....	DIL	EA 2
2	38	XDHZZ		80063	SM-C-761619	PAD, CELLULAR, RUBBER.....	DIL	EA 1
2	39	XDHHH		80063	SM-D-761612	COVER ASSEMBLY.....	DIL	EA 1

SECTION II

TM 11-5826-251-24P

(1) ILLUSTRATION		(2)	(3)	(4)	(5)	(6) DESCRIPTION	(7)	(8)
(a) FIG NO.	(b) ITEM NO.	SMR CODE	NATIONAL STOCK NUMBER	FSCM	PART NUMBER	USABLE ON CODE	U/M	QTY INC IN UNIT
2	40	XDHZZ		80063	SM-C-761618	GASKET, PROT COVER.....	DIL	EA 1
2	41	XDHZZ		80063	SM-C-761617-3	PAD, CELLULAR RUBBER	DIL	EA 2
2	42	XDHHH		80063	SM-D-762240	CABLE ASSY, POWER	DIL	EA 1
2	43	PAHZZ	5935-00-588-0857	02660	126-217	CONNECTOR, PLUG, ELEC	DIL	EA 1
2	44	XDHZZ		06324	G-1338A4	STUFFING TUBE	DIL	EA 1
2	45	PAHZZ	5305-00-054-6650	96906	MS51957-26	SCREW, MACHINE	DIL	EA 4
2	46	PAHZZ	5340-00-134-3493	80063	SM-C-447321-2	STRIKE, CATCH	DIL	EA 2
2	47	XDHZZ		94075	02159A	CONNECTOR, RECEPTACL.....	DIL	EA 1
2	48	PAOZZ	6135-00-926-8322	80058	BA4386/PRC-25	BATTERY, DRY.....	DIL	EA 1
2	49	PDOHA	5820-00-086-7148	80058	CY-2562/PRC-25	BATTERY BOX.....	DIL	EA 1
GROUP 0107 POWER SUPPLYASSEMBLY 1A7								
2	50	PAHDL	5825-01-051-4153	80063	SM-D-761689	POWER SUPPLY	DIL	EA 1
2	51	PADZZ	5935-00-498-5785	81349	M24308-1-2	CONNECTOR, RECEPTACL.....	DIL	EA 1
2	52	PADZZ	5310-00-595-6211	96906	MS15795-803	WASHER, FLAT	DIL	EA 2
2	53	PADZZ	5310-00-933-8118	96906	MS35338-135	WAHER, LOCK	DIL	EA 2
2	54	PADZZ	5305-00-054-5646	96906	MS51957-12	SCREW, MACHINE	DIL	EA 2
2	55	XDDZZ		81349	FL11CW1ED3-23	FILTER, RADIO FREQUE	DIL	EA 5
2	56	XDDZZ		80063	SM-C-44705	CONN, RCPT, ELEC	DIL	EA 1
2	57	PADZZ	5310-00-595-6761	96906	MS15795-802	WASHER, FLAT	DIL	EA 4
2	58	PADZZ	5310-00-928-2690	96906	MS35338-134	WASHER, LOCK	DIL	EA 4
2	59	PADZZ	5305-00-054-5637	96906	MS51957-3	SCREW, MACHINE.....	DIL	EA 4
2	60	PAOZZ	5920-00-926-7445	81349	FM02-125V-3A	FUSE, CARTRIDGE	DIL	EA 2
2	61	XDDZZ		80063	SM-C-761504	NUT, SPACER.....	DIL	EA 4
12/(13 BLANK)								

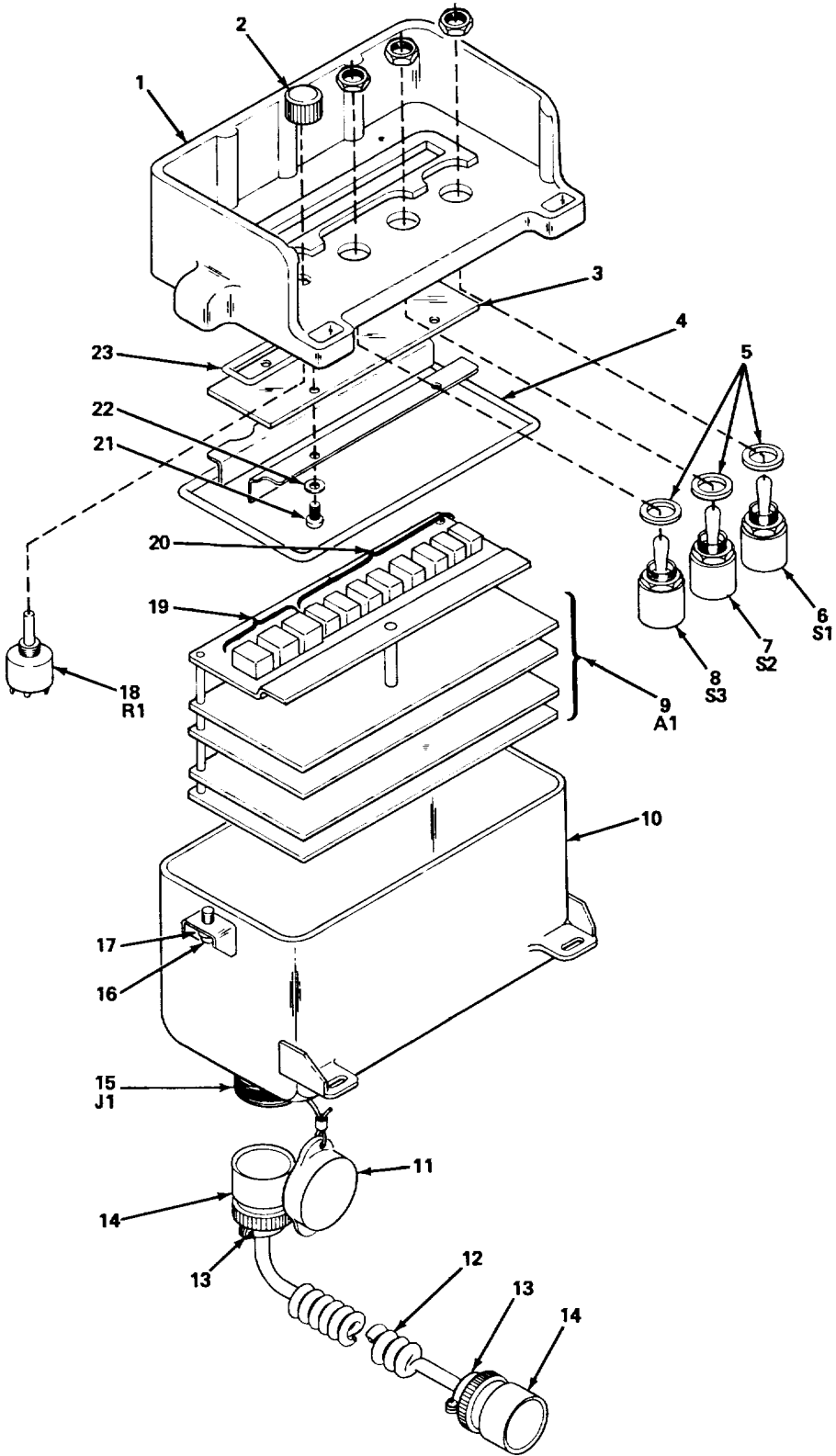

ELOCO006

Figure 3. Control Indicator C-9574/PSN-6

SECTION II

TM 11-5826-251-24P

(1) ILLUSTRATION		(2)	(3)	(4)	(5)	(6)	(7)	(8)
(a) FIG NO.	(b) ITEM NO.	SMR CODE	NATIONAL STOCK NUMBER	FSCM	PART NUMBER	DESCRIPTION USABLE ON CODE	U/M	QTY INC IN UNIT
GROUP 02 CONTROL INDICATOR C-9547/PSN-6								
3	1	PDHHD	5825-01-084-5310	80063	SM-D-761603	PANEL ASSEMBLY, CONT.....	DIL	EA 1
3	2	PAHZZ	5355-00-685-4688	96906	MS91528-1D1B	KNOB	DIL	EA 1
3	3	XDHZZ		07700	71-00324	WINDOW, EMI/RFI.....	DIL	EA 1
3	4	XDHZZ		18565	19-04-4224-1250	SHIELDING GASKET, EL.....	DIL	EA 1
3	5	PAHZZ	5330-00-806-8769	96906	MS25196-1	PACKING WITH RETAIN	DIL	EA 3
3	6	XDHZZ		21793	8906K2704	SWITCH, TOGGLE.....	DIL	EA 1
3	7	PAHZZ	5930-00-190-6110	27193	8869K11	SWITCH, TOGGLE.....	DIL	EA 1
3	8	XDHZZ		27193	8869K9	SWITCH, TOGGLE.....	DIL	EA 1
3	9	PAHDL	5825-01-084-5311	80063	SM-D-761596	LOGIC MODULE ASSEMB.....	DIL	EA 1
3	10	XDDZZ		80063	SM-D-761588	CASE, CONT-IND.....	DIL	EA 1
3	11	PAHZZ	5985-01-084-5308	80063	SM-D-761605	CAP ASSEMBLY, PROTEC	DIL	EA 1
3	12	PAOHH	5825-01-069-6889	80093	SM-D-762539	CABLE ASSEMBLY, SPEC	DIL	EA 1
3	13	XDHZZ		07418	S983-124R-1.25-4	ADAPTER, CABLE CLAMP	DIL	EA 2
3	14	XDHZZ		96906	MS3116E-12-8P	CONNECTOR, PLUG, ELEC.....	DIL	EA 2
3	15	XDHZZ		80063	SM-C-762551-002	CONNECTOR, RECEPTACL.....	DIL	EA 1
3	16	PAHZZ	5310-00-933-8119	96906	MS35338-137	WASHER, LOCK	DIL	EA 2
3	17	PAHZZ	5305-01-084-5320	80063	SM-C-649767-3	SCREW, EXTERNALLY RE	DIL	EA 2
3	18	PAHZZ	5905-00-481-7984	81349	RV6SAYS104A	RESISTOR, VARIABLE, N	DIL	EA 1
3	19	XDHZZ		28564	0-63	INDICATOR, DIGITAL D.....	DIL	EA 3
3	20	XDHZZ		28564	06-30	READOUT, INCANDESCEN	DIL	EA 8
3	21	PAHZZ	5305-00-054-5637	96906	MS51957-3	SCREW, MACHINE	DIL	EA 4
3	22	PAHZZ	5310-00-595-6761	96906	MS15795-802	WASHER, FLAT	DIL	EA 4
3	23	PAHZZ	5999-01-090-1452	18565	SM-A-761761	SHIELDING GASKET, EL.....	DIL	EA 1
15/(16 BLANK)								

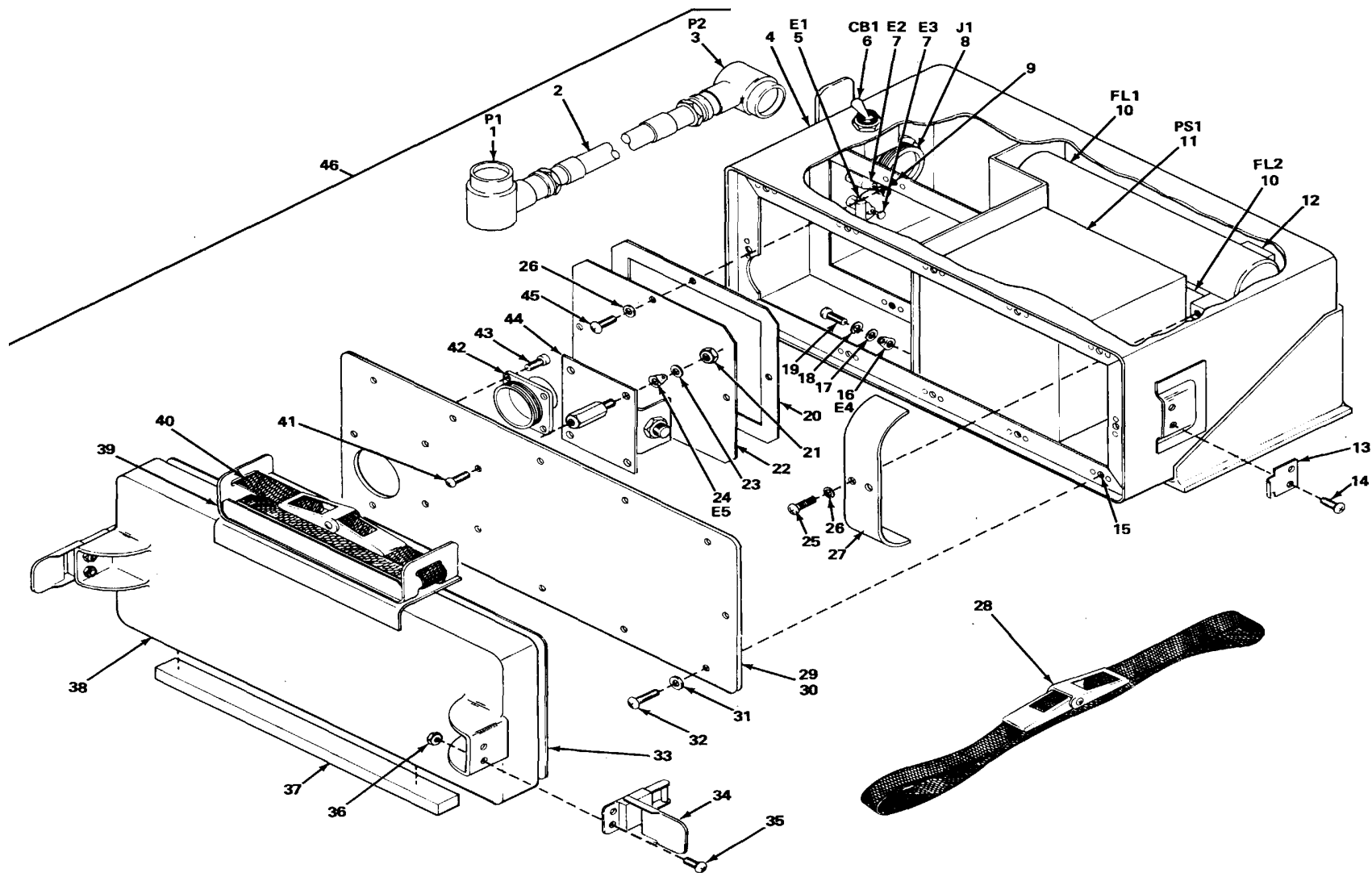

ELOCO007

Figure 4. Vehicle Mount Adapter (Sheet 1 of 2).

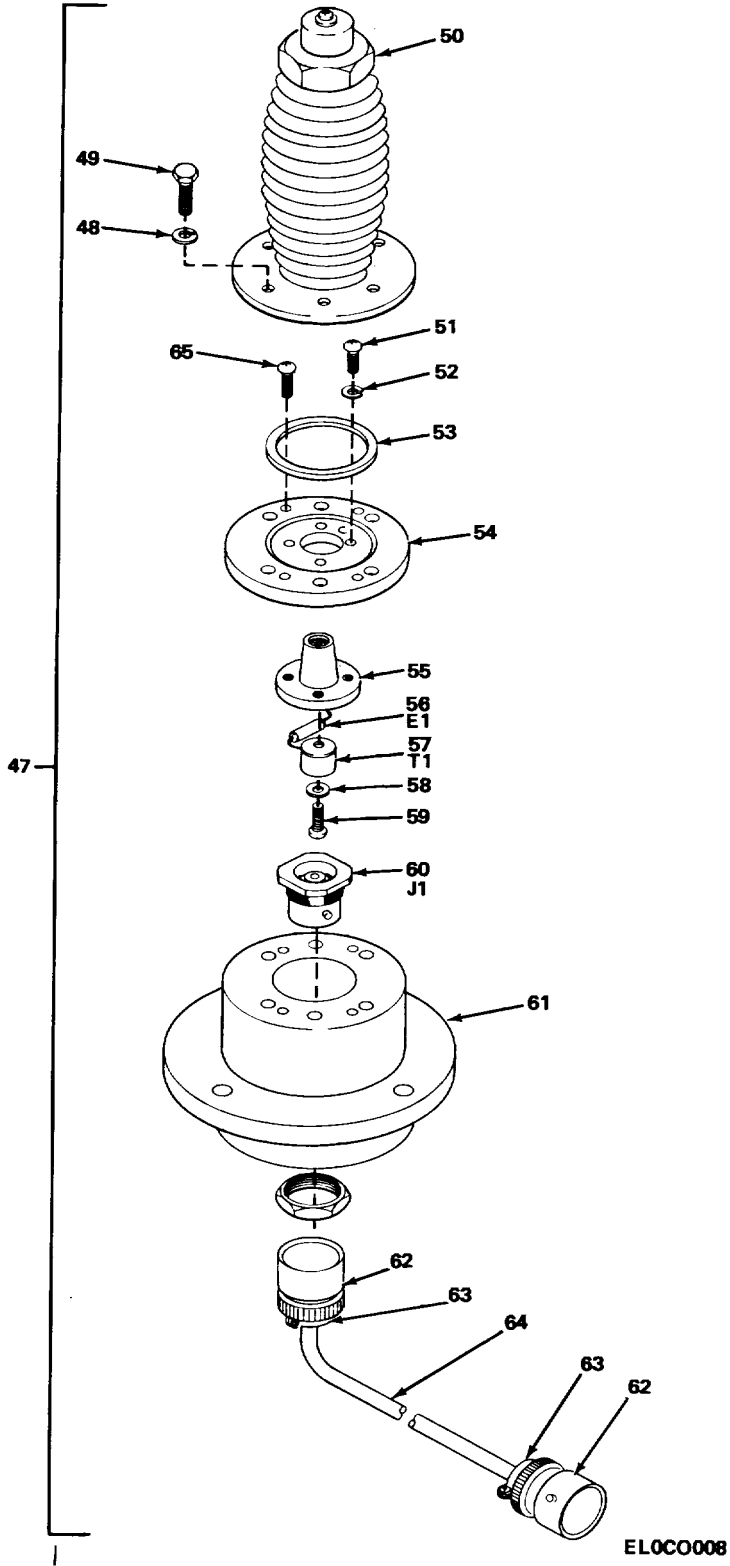

Figure 4. Vehicle Mount Adapter (Sheet 2 of 2).

SECTION II

TM 11-5826-251-24P

(1) ILLUSTRATION		(2)	(3)	(4)	(5)	(6)	(7)	(8)
(a) FIG NO.	(b) ITEM NO.	SMR CODE	NATIONAL STOCK NUMBER	FSCM	PART NUMBER	DESCRIPTION USABLE ON CODE	U/M	QTY INC IN UNIT
GROUP 03 VEHICLE MOUNT ADAPTER								
4	1	PAHZZ	5935-00-921-3398	81349	MW10MMA17	CONNECTOR, PLUG, ELEC.....	DIM	EA 1
4	2	XDOHH		80063	SM-D-762101	CABLE ASSEMBLY, POWE.....	DIM	EA 1
4	3	PAHZZ	5935-00-921-3399	81349	MW10FMA17	CONNECTOR, PLUG, ELEC.....	DIM	EA 1
4	4	XDHZZ		80063	SM-D-761664	CASE ASSY, VEH MT.....	DIM	EA 1
4	5	PAHZZ	5920-01-084-0875	74276	UMT(1)-.55	ARRESTOR, ELECTRICAL.....	DIM	EA 1
4	6	PAHZZ	5925-01-036-6628	81349	M39019/01-224	CIRCUIT BREAKER.....	DIM	EA 1
4	7	XDHZZ		81349	SE09E01	TERMINAL, STUD.....	DIM	EA 1
4	8	XDHZZ		81349	MW20MMA00	CONNECTOR, PLUG, ELEC.....	DIM	EA 1
4	9	PAHZZ	5310-00-728-8528	96906	MS21070L04	NUT, SELF-LOCKING, PL.....	DIM	EA 4
4	10	PAHZZ	5915-01-085-9707	13619	RF5985	FILTER, RADIO FREQUE.....	DIM	EA 2
4	11	PAHDL	6130-01-080-7805	15755	C12D20	POWER SUPPLY.....	DIM	EA 1
4	12	XDHZZ		80063	SM-B-762544-1	CUSHION.....	DIM	EA 2
4	13	PAHZZ	5820-00-973-1730	80063	SM-C-447321	FLUSH CATCH.....	DIM	EA 2
4	14	PAHZZ	5305-00-054-6650	96906	MS51957-26	SCREW, MACHINE.....	DIM	EA 4
4	15	PAHZZ	5310-00-728-8529	96906	MS21070L06	NUT, SELF-LOCKING, PL.....	DIM	EA 12
4	16	PAHZZ	5940-00-583-7741	96906	MS77068-4	TERMINAL, LUG.....	DIM	EA 1
4	17	PAHZZ	5310-00-680-7296	80205	NAS620-10L	WASHER, FLAT.....	DIM	EA 4
4	18	PAHZZ	5310-00-933-8120	96906	MS35338-138	WASHER, LOCK.....	DIM	EA 4
4	19	PAHZZ	5305-00-057-4593	96906	MS16996-9	SCREW, CAP, SOCKET HE.....	DIM	EA 4
4	20	XDHZZ		80063	SM-C-761675	GASKET, SHLD, ELEC.....	DIM	EA 1
4	21	PAHZZ	5310-00-982-4999	96906	MS21044C04	NUT, SELF-LOCKING, HE.....	DIM	EA 4
4	22	XDHZZ		80063	SM-C-761673	COVER, INTERNAL.....	DIM	EA 1
4	23	PAHZZ	5310-00-595-6211	96906	MS15795-803	WASHER, FLAT.....	DIM	EA 4
4	24	PAHZZ	5940-00-682-2477	96906	MS77068-1	TERMINAL, LUG.....	DIM	EA 1
4	25	XDHZZ	5305-00-054-5647	96906	MS51957-13	SCREW, MACHINE.....	DIM	EA 2
4	26	PAHZZ	5310-00-933-8118	96906	MS35338-135	WASHER, LOCK.....	DIM	EA 2
4	27	XDHZZ		80063	SM-C-762545	CLAMP, LOOP.....	DIM	EA 1
4	28	PAOZZ	5340-01-084-2190	08992	CT1126	STRAP, WEBBING.....	DIM	EA 1
4	29	XDHDD		80063	SM-D-761668	COVER ASSY, ACCESS.....	DIM	EA 1
4	30	XDHZZ		80063	SM-D-761667	COVER, ACCESS.....	DIM	EA 1
4	31	PAHZZ	5310-00-722-5998	96906	MS15795-805	WASHER, FLAT.....	DIM	EA 12
4	32	PAHZZ	5305-00-054-6651	96906	MS51957-27	SCREW, MACHINE.....	DIM	EA 12
4	33	XDHZZ		80063	SM-C-761655	GASKET.....	DIM	EA 1
4	34	PAHZZ	5340-00-236-0638	80063	SM-C-447321-1	CATCH, CLAMPING.....	DIM	EA 2
4	35	PAHZZ	5305-00-054-6652	96906	MS51957-28	SCREW, MACHINE.....	DIM	EA 4
4	36	PAHZZ	5310-00-982-6813	96906	MS21044-C06	NUT, SELF-LOCKING, HE.....	DIM	EA 4
4	37	XDHZZ		80063	SM-C-761654	PAD.....	DIM	EA 1
4	38	XDHHH		80063	SM-D-761658	COVER ASSY, PROT.....	DIM	EA 1
4	39	XDHZZ		80063	SM-C-761656	CUSHION.....	DIM	EA 1

SECTION II

TM 11-5826-251-24P

(1) ILLUSTRATION		(2)	(3)	(4)	(5)	(6)	(7)	(8)
(a) FIG NO.	(b) ITEM NO.	SMR CODE	NATIONAL STOCK NUMBER	FSCM	PART NUMBER	DESCRIPTION USABLE ON CODE	U/M	QTY INC IN UNIT
4	40	PAOZZ	5340-01-086-8903	08992	CT1125	STRAP, WEBBING..... DIM	EA	1
4	41	PAHZZ	5305-00-780-8456	96906	MS24693-C9	SCREW, MACHINE..... DIM	EA	4
4	42	PAHZZ	5935-01-080-7827	80063	SM-C-761669	CONNECTOR, RECEPTAC..... DIM	EA	1
4	43	XDHZZ		80063	SM-A-761677	SCREW, SHOULDER..... DIM	EA	4
4	44	PAHDL	5825-01-080-7872	80063	SM-D-761661	CIRCUIT CARD ASSEMB..... DIM	EA	1
4	45	PAHZZ	5305-00-054-5649	96906	MS51957-15	SCREW, MACHINE..... DIM	EA	4
4	46	PDODD	5825-01-076-8028	80063	SM-D-761663	MOUNT, NAVIGATIONAL..... DIM	EA	1
4	47	PDHHA	5825-01-080-7755	80063	SM-D-761622	ANTENNA, VEHICLE BAS..... DIM	EA	1
4	48	PAHZZ	5310-00-933-8121	96906	MS35338-139	WASHER, LOCK..... DIM	EA	6
4	49	PAHZZ	5305-00-685-3511	96906	MS35308-306	SCREW, CAP, HEXAGON H..... DIM	EA	6
4	50	PAHZZ	5985-00-832-8776	80063	SM-D-542042	CABLE, MOUNT ASSEMBL..... DIM	EA	1
4	51	PAHZZ	5305-00-054-5637	96906	MS51957-3	SCREW, MACHINE..... DIM	EA	4
4	52	PAHZZ	5310-00-676-8061	80205	NAS1640-0	WASHER, LOCK..... DIM	EA	4
4	53	PAHZZ	5330-00-625-0466	96906	MS9068-223	PACKING, PREFORMED..... DIM	EA	1
4	54	XDHZZ		80063	SM-C-761621	ADAPTER..... DIM	EA	1
4	55	XDHZZ		80063	SM-C-761625	CONTACT ASSY, ELEC..... DIM	EA	1
4	56	PAHZZ	5920-01-084-0875	74276	UMT(1)-.55	ARRESTOR, ELECTRICAL..... DIM	EA	1
4	57	XDHZZ		80063	SM-D-762005	TRANSFORMER, ANTENNA..... DIM	EA	1
4	58	PAHZZ	5310-00-043-4708	80205	NAS620C2	WASHER, FLAT..... DIM	EA	1
4	59	PAHZZ	5305-00-054-5643	96906	MS51957-9	SCREW, MACHINE..... DIM	EA	1
4	60	XDHZZ		96906	MS3114H12-8SW	CONNECTOR, PLUG, ELEC..... DIM	EA	1
4	61	PDHHA	5825-01-069-6873	80063	SM-D-761626	BASE, ANTENNA..... DIM	EA	1
4	62	PAHZZ	5935-01-085-0545	96906	MS3116E12-8PW	CONNECTOR, PLUG, ELEC..... DIM	EA	2
4	63	XDHZZ		07418	S983-124R-1.25-4	ADAPTER, CABLE CLAMP..... DIM	EA	2
4	64	XDOHH		80063	SM-D-762541	CABLE ASSEMBLY, RADI..... DIM	EA	1
4	65	PAHZZ	5305-00-079-5835	96906	MS24693C50	SCREW, MACHINE..... DIM	EA	4

SECTION IV

TM 11-5826-251-24P

NATIONAL STOCK NUMBER INDEX

STOCK NUMBER	FIGURE NO.	ITEM NO.	STOCK NUMBER	FIGURE NO.	ITEM NO.
5310-00-043-4708	4	58	5935-00-921-3398	4	1
5305-00-054-5637	2	59	5935-00-921-3399	4	3
5305-00-054-5637	3	21	5330-00-925-0466	4	53
5305-00-054-5637	4	51	5920-00-926-7445	2	60
3005-00-054-5643	2	16	6135-00-926-8322	2	48
5305-00-054-5643	4	59	5310-00-928-2690	2	17
5305-00-054-5646	2	13	5310-00-928-2690	2	58
5305-00-054-5646	2	54	5820-00-930-0724	2	23
5305-00-054-5647	4	25	5310-00-933-8118	2	53
5305-00-054-5649	4	45	5310-00-933-8118	4	26
5305-00-054-6650	2	31	5310-00-933-8119	3	16
5305-00-054-6650	2	45	5310-00-933-8120	4	18
5305-00-054-6650	4	14	5310-00-933-8121	4	48
5305-00-054-6651	4	32	5310-00-934-9748	2	14
5305-00-054-6652	2	29	5820-00-973-1730	4	13
5305-00-054-6652	4	35	5310-00-982-4999	4	21
5305-00-054-6654	2	22	5310-00-982-6813	2	27
5305-00-057-4593	4	19	5310-00-982-6813	4	36
5305-00-079-5835	4	65	5925-01-036-6628	4	6
5820-00-086-7148	2	49	5825-01-051-4145	2	4
5340-00-134-3493	2	30	5825-01-051-4146	2	6
5340-00-134-3493	2	46	5825-00-051-4153	2	50
5930-00-190-6110	3	7	5825-01-051-4158	2	3
5340-00-205-5184	2	28	5825-01-051-4159	2	5
5340-00-236-0638	2	34	5825-01-069-6872	1	3
5340-00-236-0638	4	34	5825-01-069-6873	4	61
4820-00-296-9677	2	32	5825-01-069-6889	3	12
5905-00-481-7984	3	18	5825-01-076-8028	4	46
5935-00-498-5785	2	51	5825-01-076-8067	1	1
5940-00-583-7741	4	16	5825-01-076-8067	1	2
5935-00-588-0857	4	43	5825-01-080-7755	4	47
5310-00-595-6211	2	52	6130-01-080-7805	4	11
5310-00-595-6211	4	23	5935-01-080-7827	4	42
5310-00-595-6761	2	18	5825-01-080-7872	4	44
5310-00-595-6761	2	57	5920-01-084-0875	4	5
5310-00-595-6761	3	22	5920-01-084-0875	4	56
5310-00-676-8061	4	52	5340-01-084-2190	4	28
5310-00-680-7296	4	17	5985-01-084-5307	2	8
5940-00-682-2477	2	12	5985-01-084-5308	2	33
5940-00-682-2477	4	24	5985-01-084-5308	3	11
5305-00-685-3511	4	49	5935-01-084-5309	2	20
5355-00-685-4688	3	2	5825-01-084-5310	3	1
5310-00-722-5998	2	21	5825-01-084-5311	3	9
5310-00-722-5998	4	31	5305-01-084-5320	3	17
5310-00-728-8528	4	9	5935-01-085-0545	4	62
5310-00-728-8529	4	15	5915-01-085-9707	4	10
5305-00-780-8456	4	41	5340-01-086-8903	2	24
5330-00-806-8769	3	5	5340-01-086-8903	4	40
5985-00-832-8776	4	50	5999-01-090-1452	3	23
5820-00-889-3803	1	4			

FSCM	PART NUMBER	FIGURE NO.	ITEM NO.	FSCM	PART NUMBER	FIGURE NO.	ITEM NO.
80058	AT-892/PRC-25	1	4	96906	MS24693C50	4	65
80058	BA4386/PRC-25	2	48	96906	MS25196-1	3	5
08992	CT1125	2	24	96906	MS3114H12-8SW	4	60
08992	CT1125	4	40	96906	MS3114H128SW	2	9
08992	CT1126	4	28	96906	MS3116E-12-8P	3	14
80058	CY-2562/PRC-25	2	49	96906	MS3116E12-8PW	4	62
15755	C12D20	4	11	96906	MS35308-306	4	49
81349	FL11CW1ED3-23	2	55	96906	MS35338-134	2	17
81349	FM02-125V-3A	2	60	96906	MS35338-134	2	58
06324	G-1338A4	2	44	96906	MS35338-135	2	53
81349	MILV55341	2	32	96906	NS35338-135	4	16
96906	MS15795-802	2	18	96906	MS35338-137	3	16
96906	MS15795-802	2	57	96906	MS35338-138	4	18
96906	MS15795-802	3	22	96906	MS35338-139	4	48
96906	MS15795-803	2	52	96906	MS35649-244	2	14
96906	MS15795-803	4	23	96906	MS51957-12	2	13
96906	MS15795-805	2	21	96906	MS51957-12	2	54
96906	MS15795-805	4	31	96906	MS51957-13	4	25
96906	MS16996-9	4	19	96906	MS51957-15	4	45
96906	MS21044-C06	2	27	96906	MS51957-26	2	31
96906	MS21044-C06	4	36	96906	MS51957-26	2	45
96906	MS21044C04	4	21	96906	MS51957-26	4	14
96906	MS21070L04	4	9	96906	MS51957-27	4	32
96906	MS21070L06	4	15	96906	MS51957-28	2	29
96906	MS24693-C9	4	41	96906	MS51957-28	4	35

NATIONAL STOCK NUMBER AND PART NUMBER INDEX

FSCM	PART NUMBER	FIGURE NO.	ITEM NO.	FSCM	PART NUMBER	FIGURE NO.	ITEM NO.
96906	MS51957-3	2	59	80063	SM-C-762545	4	27
96906	MS51957-3	3	21	80063	SM-C-762551-002	3	15
96906	MS51951-3	4	51	80063	SM-D-542042	4	50
96906	MS51957-30	2	22	80063	SM-D-761496	2	3
96906	MS51957-9	2	16	80063	SM-D-761499	2	5
96906	MS51957-9	4	59	80063	SM-D-761536	2	6
96906	MS77068-1	2	12	80063	SM-D-761580	1	2
96906	MS77068-1	4	24	80063	SM-D-761588	3	10
96906	MS77068-4	4	16	80063	SM-D-761596	3	9
96906	MS9068-223	4	53	80063	SM-D-761598	2	8
96906	MS91528-1D1B	3	2	80063	SM-D-761603	3	1
81349	MW10FMA17	4	3	80063	SM-D-761605	2	33
81349	MW10MMA17	4	1	80063	SM-D-761605	3	11
81349	MW20MMA00	4	8	80063	SM-D-761612	2	39
81349	M24308-1-2	2	51	80063	SM-D-761622	4	47
81349	M39019/01-224	4	6	80063	SM-D-761626	4	61
80205	NAS1640-0	4	52	80063	SM-D-761658	2	26
80205	NAS620-10L	4	17	80063	SM-D-761658	4	38
80205	NAS620C2	4	58	80063	SM-D-761661	4	44
80058	OF-34/PSN-6	1	3	80063	SM-D-761663	4	46
13619	RF5985	4	10	80063	SM-D-761664	4	4
81349	RY6SAYSXD104A	3	18	80063	SM-D-761667	4	30
81349	SE09E01	4	7	80063	SM-D-761668	4	29
81349	SE18E01	2	10	80063	SM-D-761687	2	7
80063	SM-A-761677	4	43	80063	SM-D-761689	2	50
18565	SM-A-761761	3	23	80063	SM-D-762005	2	19
18565	SM-A-761761-001	2	37	80063	SM-D-762005	4	57
18565	SM-A-761761-002	2	35	80063	SM-D-762101	4	2
80063	SM-B-447320	2	23	80063	SM-D-762240	2	42
80063	SM-B-762544-1	4	12	80063	SM-D-762539	3	12
80063	SM-C-44705	2	56	80063	SM-D-762541	4	64
80063	SM-C-447321	4	13	80063	SM-D-762590	2	15
80063	SM-C-447321-1	2	34	80063	SM-D-762594	2	2
80063	SM-C-447321-1	4	34	80063	SM-D-762597	2	2A
80063	SM-C-447321-2	2	30	80063	SM-D-762600	2	4
80063	SM-C-447321-2	2	46	80063	SM-D-762604	1	1
80063	SM-C-649767-3	3	17	07418	S983-124R-1.25-4	3	13
80063	SM-C-761504	2	61	07418	S983-124R-1.25-4	4	63
80063	SM-C-761609	2	20	74276	UMT(1)-.55	4	5
80063	SM-C-761617-2	2	36	74276	UMT(1)-.55	4	56
80063	SM-C-761617-3	2	41	74276	UMT(1)-550	2	11
80063	SM-C-761618	2	40	28564	0-63	3	19
80063	SM-C-761619	2	38	94075	02159A	2	47
80063	SM-C-761621	4	54	28564	06-30	3	20
80063	SM-C-761625	4	55	02660	126-217	2	43
80063	SM-C-761654	4	37	14608	15834	2	28
80063	SM-C-761655	2	25	18565	19-04-4224-1250	3	4
80063	SM-C-761655	4	33	07700	71-00324	3	3
80063	SM-C-761656	4	39	27193	8869K11	3	7
80063	SM-C-761669	4	42	27193	8869K9	3	8
80063	SM-C-761673	4	22	27193	8906K2704	3	6
80063	SM-C-761675	4	20				

RECOMMENDED CHANGES TO EQUIPMENT TECHNICAL PUBLICATIONS



THEN... JOT DOWN THE DOPE ABOUT IT ON THIS FORM, CAREFULLY TEAR IT OUT, FOLD IT AND DROP IT IN THE MAIL!

SOMETHING WRONG WITH THIS PUBLICATION?

FROM: (PRINT YOUR UNIT'S COMPLETE ADDRESS)

DATE SENT

PUBLICATION NUMBER

TM 11-5825-270-10

PUBLICATION DATE

23 Jul 81

PUBLICATION TITLE

Radio Frequency R-2176/FRN

BE EXACT... PIN-POINT WHERE IT IS

PAGE NO.

PARA-GRAPH

FIGURE NO.

TABLE NO.

IN THIS SPACE TELL WHAT IS WRONG AND WHAT SHOULD BE DONE ABOUT IT:

TEAR ALONG PERFORATED LINE

PRINTED NAME, GRADE OR TITLE, AND TELEPHONE NUMBER

SIGN HERE:

DA FORM 2028-2
1 JUL 79

PREVIOUS EDITIONS ARE OBSOLETE.

P.S.—IF YOUR OUTFIT WANTS TO KNOW ABOUT YOUR RECOMMENDATION MAKE A CARBON COPY OF THIS AND GIVE IT TO YOUR HEADQUARTERS.

By Order of the Secretary of the Army:

Official:

ROBERT M. JOYCE
Brigadier General, United States Army
The Adjutant General

E. C. MEYER
General, United States Army
Chief of Staff

